

*For more info about compatibility with other models
please see the sticker on the skid plate

TOYOTA LAND CRUISER 78/79

No.: 2333.5787.1/6 Gearbox & transfer case
2333.5788.1/6 Fuel tank

Body: All
Year: 2007-
Engine: 4.2
Transmission: MT

FITTING KIT

1. Bolt M8x20.....	4 pc
2. Bolt M10x30.....	20 pc
3. Washer 8.....	4 pc
4. Washer 10.....	20 pc
5. Insert nut M10.....	2 pc
6. Insert nut M10x100/50.....	3 pc
7. Bracket 1.....	2 pc
8. Bracket 2.....	2 pc
9. Bracket 3.....	1 pc

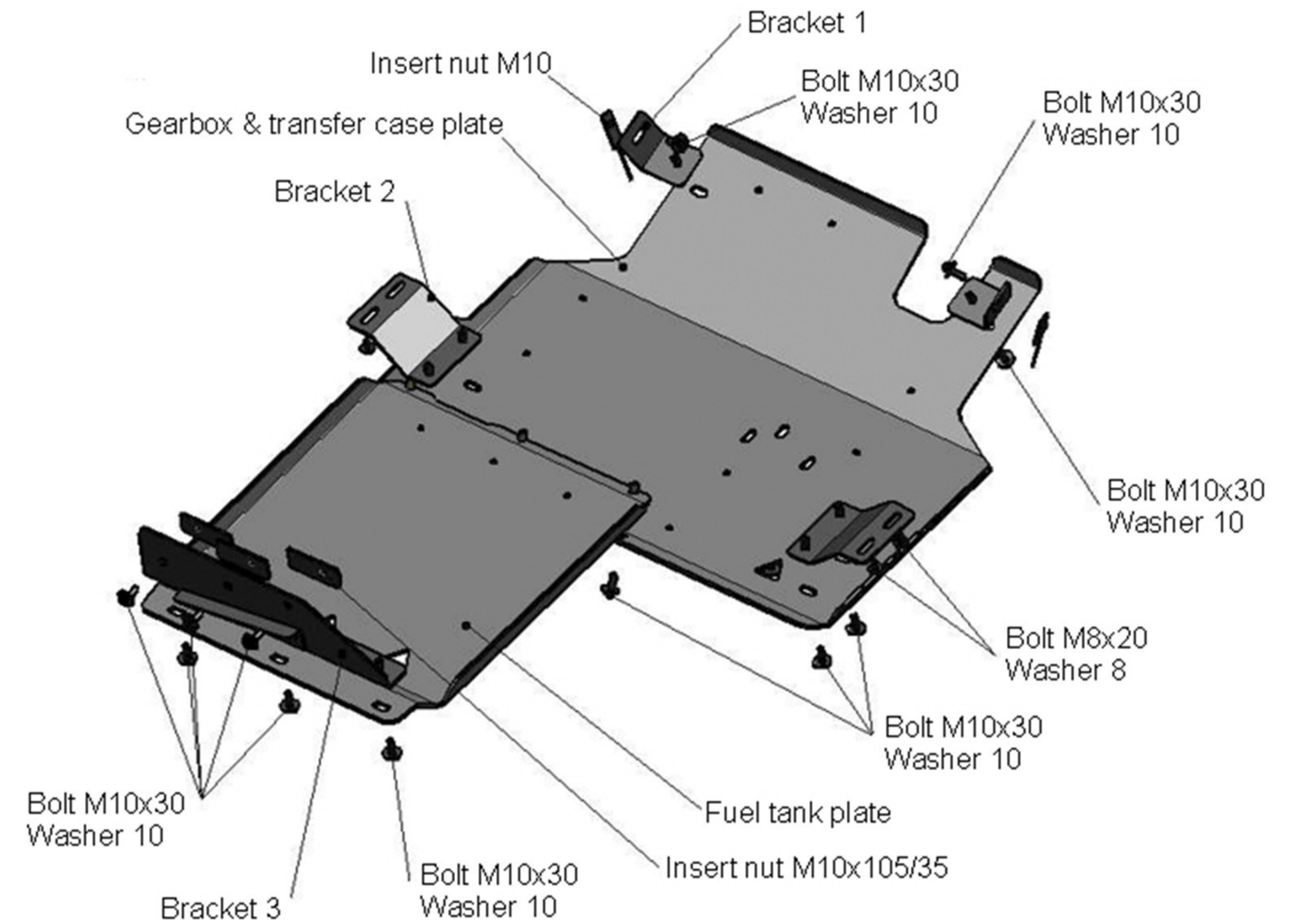

INSTALLATION INSTRUCTIONS

1. Remove original guard from transfer case and fuel pipes.
2. Mount brackets 1 to underframe with insert nuts M10 and bolts M10x30.
3. Mount brackets 2 to original threaded apertures of underframe with bolts M8x20.
4. Mount bracket 3 to underframe with bolts M10x30 and insert nuts M10x100/50.
5. Fix gearbox & transfer case plate to mounted brackets 1 and 2 with bolts M10x30, then fix it to original threaded apertures of underframe with original fittings.
6. Fix front end of fuel tank plate to rear end of gearbox & transfer case plate, then fix its rear end to mounted bracket 3 with bolts M10x30.
7. Tighten all screws (50 Nm for M10, 30 Nm for M8, 10 Nm for M6). Use of pneumatic tools is prohibited.



WWW.RIVAL4X4.COM